

XOMOX[®]

brands you trust.



Pneumatic Rack and Pinion Actuators Series XRP

CRANE[®]

ChemPharma Flow Solutions

www.cranepharmasolutions.com

HOW TO SPECIFY

STOCKED ACTUATOR CONFIGURATIONS

Part Number

(Utilize 9 digits as a minimum)

Example:

Brand

Xomox :

Pinion & Porting

ISO 5211/DIN 3337 Diamond,

Gas 45° threads.

ISO 5211 Square, NPT:

Size

001, 002, 006,
012, 025, 050, 090, 130, 180,
205, 380, 630, 960, H15:

Action

Double Acting:
single acting fail close:
single acting fail open:

Springs

Double Acting, no springs:
Spring return, 02 thru 18 spring combinations:

Limit & Travel Stop

No limit or travelstops (excepted 001-006 with limit stop to open as standard)
Dual travel Stops, std on 012 to 180, Integral to design,
With 8 degrees of over travel:
Limit stop to open/close as option for sizes 205-H15:

Temperature

Standard Nitrile seals (Buna-N rubber):
Low Temperature seals:
High Temperature seals:

Coating

Standard Anodized Body & Polyurethane Coated end caps:
Consult factory for other options:

Other

Standard anodized aluminum pinion:
Consult factory for other options:

Mounting Configuration

Standard ISO F-pattern for each body size:
Refer to page 10 for optional mounting configurations:

NON-STANDARD MODIFICATIONS

Options

(Use only if non-standard required)

DESIGN FEATURES

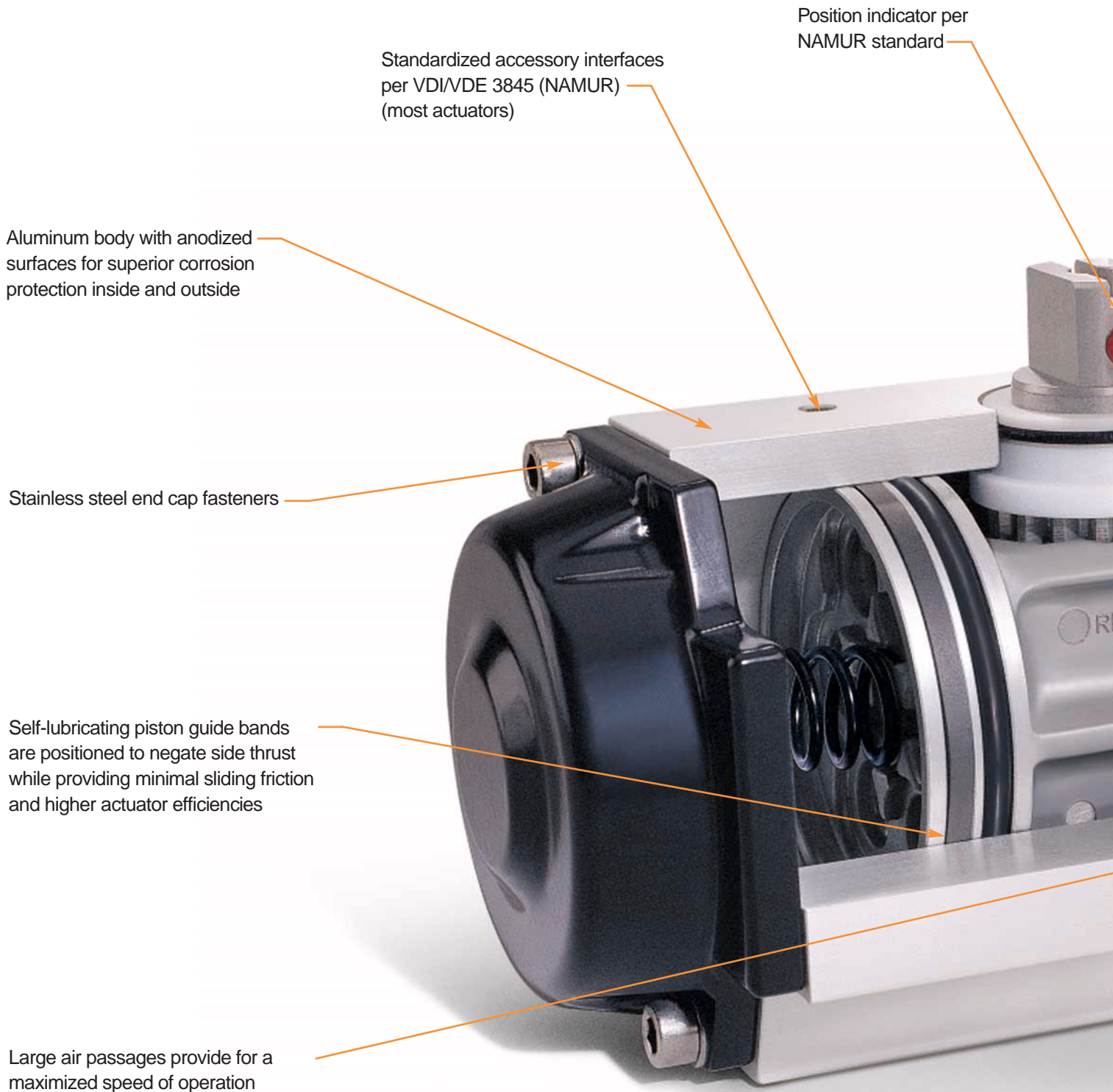

Standardized accessory interfaces
per VDI/VDE 3845 (NAMUR)
(most actuators)

Position indicator per
NAMUR standard

Aluminum body with anodized
surfaces for superior corrosion
protection inside and outside

Stainless steel end cap fasteners

Self-lubricating piston guide bands
are positioned to negate side thrust
while providing minimal sliding friction
and higher actuator efficiencies

Large air passages provide for a
maximized speed of operation

RES & BENEFITS

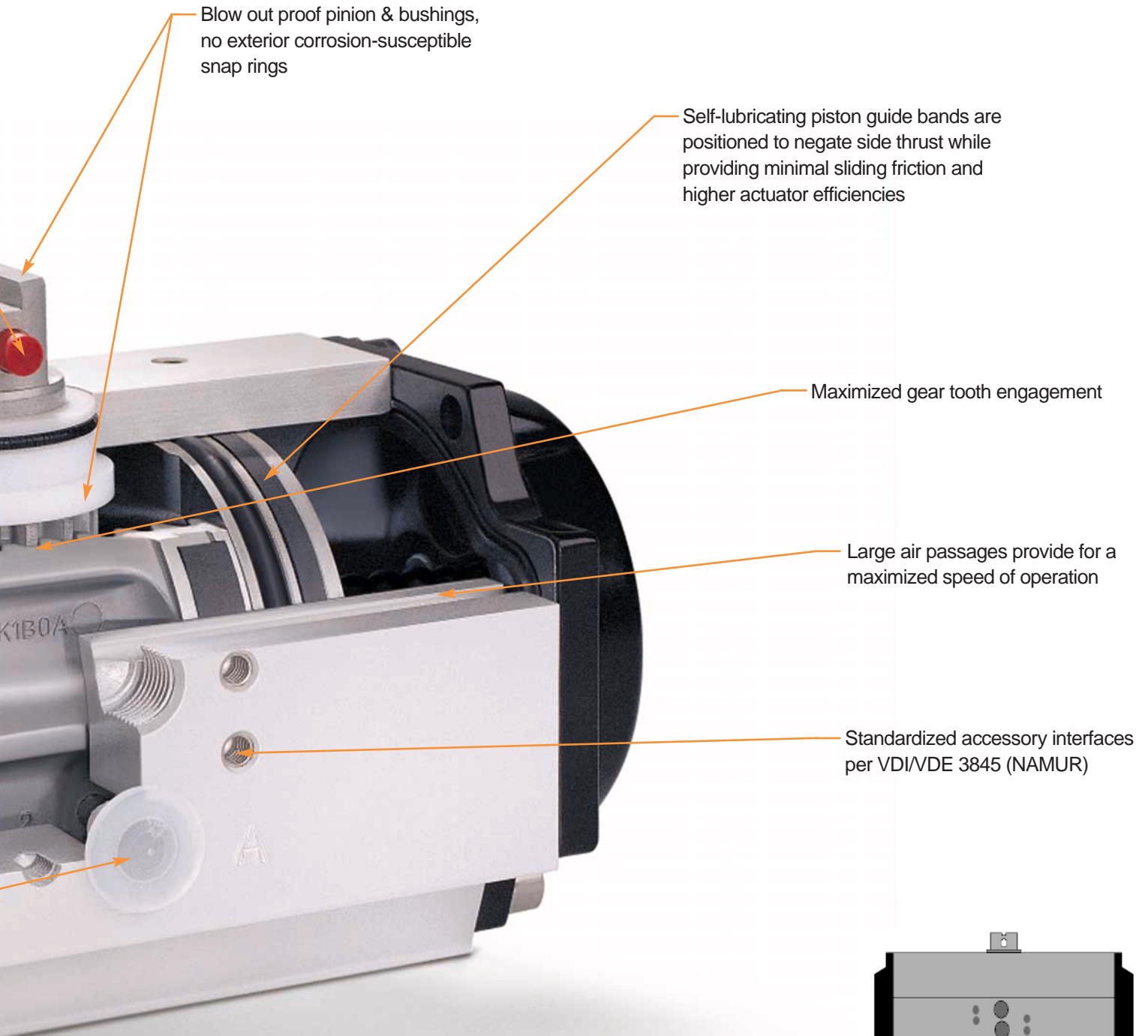

Blow out proof pinion & bushings, no exterior corrosion-susceptible snap rings

Self-lubricating piston guide bands are positioned to negate side thrust while providing minimal sliding friction and higher actuator efficiencies

Maximized gear tooth engagement

Large air passages provide for a maximized speed of operation

Standardized accessory interfaces per VDI/VDE 3845 (NAMUR)

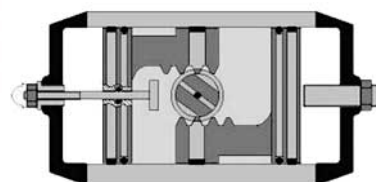

Travel Stops open/close for sizes 012 - 180

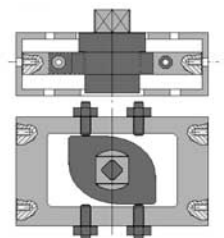
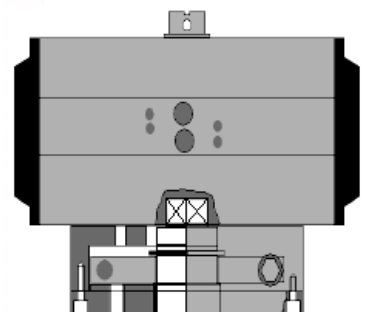

Bottom flanged external limit Stops open/close for sizes 205 - H15

GLOBAL CAPABILITIES FOR GLOBAL CUSTOMERS



Worldwide capabilities

No matter where in the world you are, located XOMOX technical support and services are available for you from:

- 18 Manufacturing Facilities
- 18 Service Centers
- 50 Sales Offices

Product selection

XOMOX offers the broadest line of process valves, actuators, accessories, and related services including:

- XOMOX Process Valves
- XOMOX XRP™ Actuators
- Saunders diaphragm valves

Global locator

For a listing of Xomox Manufacturing Facilities, Service Centers, Regional Offices, visit our web site

www.xomox.com



XOMOX®

XOMOX International GmbH & Co.

Von-Behring-Straße 15

D-88131 Lindau/Bodensee

Tel.: (49) 8382-702-0

Fax. (49) 8382-702-144

www.xomox.com

CRANE®

ChemPharma Flow Solutions

CRANE ChemPharma Flow Solutions Include: Pipe - Valves - Fittings - Actuators - Pumps

DEPA®

ELRO

PSI
LINED PIPING SYSTEMS

RESISTOFLEX®

ResistoPure

revo®

Saunders®
the science inside 

XOMOX®